

Pentair Rainbow Dynamic Series filter parts diagram

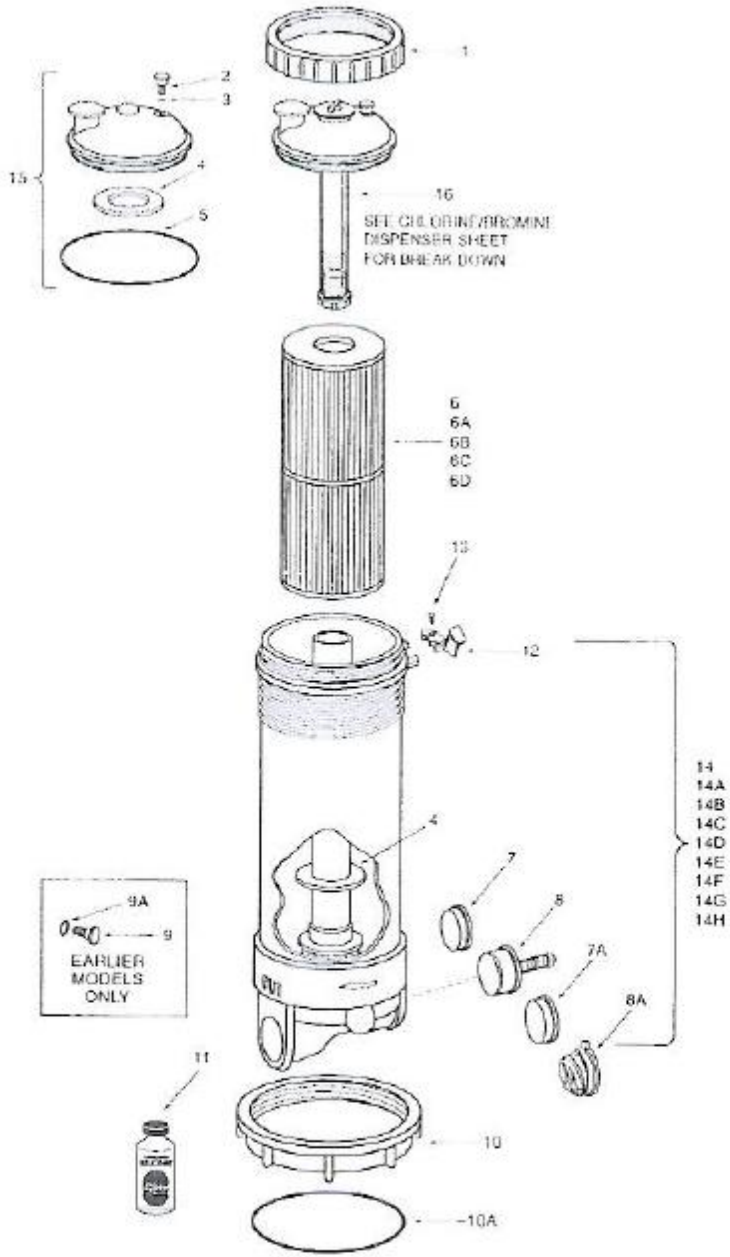

**#7, 7A #8, 8A**  
 By-pass plug for applications where 100% filtration is desired at all times. Remove **#8, 8A** by-pass assembly by inserting a rod or pipe through manifold outlet port and tap on by-pass assembly to remove. Insert **#7, 7A** by-pass plug through inlet port and into manifold until firmly seated.

## DYNAMIC® SERIES II & III

TOP LOAD CARTRIDGE FILTER MODEL RTL/RCF 1½" & 2"

### HIGH FLOW PARTS BREAKDOWN DRAWING

Item	Part No.	Qty.	Description
1	R172214	1	Lock Ring
2	R172224X	1	Air Vent Valve
3	R172221	1	O-ring, Air vent Valve
4	R172222	2	Gasket, Cartridge
5	R172223	1*	O-ring, Lid to Housing
6	R173428	1*	25 Sq. Ft. Cartridge, 6 oz.
6A	R173429	1*	25 Sq. Ft. Cartridge, 3 oz.
6B	R173434	1	50 Sq. Ft. Cartridge
6C	R173435	1	75 Sq. Ft. Cartridge
6D	R173436	1	100 Sq. Ft. Cartridge
7	R172225X	1	1½" Plug to disable by-pass
7A	R172679	1	2" Plug to disable by-pass
8	R172226X	1	1½" By-Pass Assembly
8A	R172682	1	2" By-Pass Assembly
9	R172392	2	¾" Access plug (earlier models)
9A	R172393	2	Access plug O-ring (earlier models)
10	R172370	1	Bottom Locking Flange
10A	R170070	Opt.	O-ring Locking Flange
11	R172036	Opt.	Silicone Lubricant
12	R172374	1	Lock Spring
13	R172375	1	Lock Screw
14	R172386	1**	RTL/RCF-25 housing assembly 1½" slip
14A	R172387	1**	RTL/RCF-25 housing assembly 1½" FPT
14B	R172388	1**	RTL/RCF-50 housing assembly 1½" slip
14C	R172389	1**	RTL/RCF-50 housing assembly 1½" FPT
14D	R172390B	1**	RTLB-25 housing assembly
14E	R172421	1**	RTL/RCF-25 housing assembly 2" slip
14F	R172428	1**	RTL/RCF-50 housing assembly 2" slip
14G	R172638	1**	RTL/RCF-75 housing assembly 2" slip
14H	R172639	1**	RTL/RCF-100 housing assembly 2" slip
15	R172385	1**	Lid Assembly complete for RTL only
16	R172540	1**	Chlorine/Bromine Dispenser complete-RCF
	R172452	Opt.	Free standing base
	R172580	Opt.	Tilt base mount

\*All three cartridges are interchangeable

\*\*Only one applies to your filter, check model number when ordering